

FRAME MESA ALUMINIO 200x100x76

By Ramon Esteve



FRAME Collection comes from generating serene and timeless shapes using framework as the elementary geometry. The endless possibilities offered by the material using advanced technology, was the motivation to explore the limits. The FRAME section is flared creating pieces of visual lightness while still definitive and resistant. FRAME meets a wide range of needs in any outdoor space thanks to its variety of pieces. The collection consists of high and low stools, benches, armchairs, a modular sofa, tables of various sizes, chairs and a chaiselongue. The lightness of the pieces as well as the stackable nature of some, such as the chairs and armchairs, make adjustments to their distribution easier and comfortable. Also the chaiselongue, with a reclining backrest, has wheels built into the framework which make moving it easier.

Camo rug will contrast with the surrounding by blurring it. The pattern, initially designed to get integrated with the nature, didn't take long to get into the fashion world in order to get the opposite effect at the urban environment. Today, being trendier than ever, it is available to dress your home in four different tones.

View online: <https://www.vondom.com/products/54116>

Features

Description

Extruded aluminum with cast lacquered aluminum base. HPL Table top. Item suitable for indoor and outdoor use. HPL Table top.

Weight

51.49 Kg

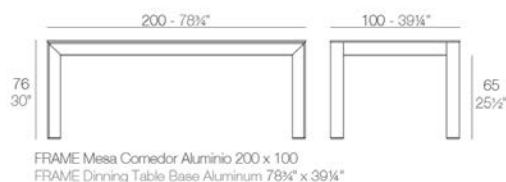



FRAME MESA ALUMINIO 300x120x76

By Ramon Esteve



FRAME Collection comes from generating serene and timeless shapes using framework as the elementary geometry. The endless possibilities offered by the material using advanced technology, was the motivation to explore the limits. The FRAME section is flared creating pieces of visual lightness while still definitive and resistant. FRAME meets a wide range of needs in any outdoor space thanks to its variety of pieces. The collection consists of high and low stools, benches, armchairs, a modular sofa, tables of various sizes, chairs and a chaiselongue. The lightness of the pieces as well as the stackable nature of some, such as the chairs and armchairs, make adjustments to their distribution easier and comfortable. Also the chaiselongue, with a reclining backrest, has wheels built into the framework which make moving it easier.

Camo rug will contrast with the surrounding by blurring it. The pattern, initially designed to get integrated with the nature, didn't take long to get into the fashion world in order to get the opposite effect at the urban environment. Today, being trendier than ever, it is available to dress your home in four different tones.

View online: <https://www.vondom.com/products/54151>

Features

Description

Extruded aluminum with cast lacquered aluminum base. HPL Table top. Item suitable for indoor and outdoor use. HPL Table top.

Weight

78.7 Kg



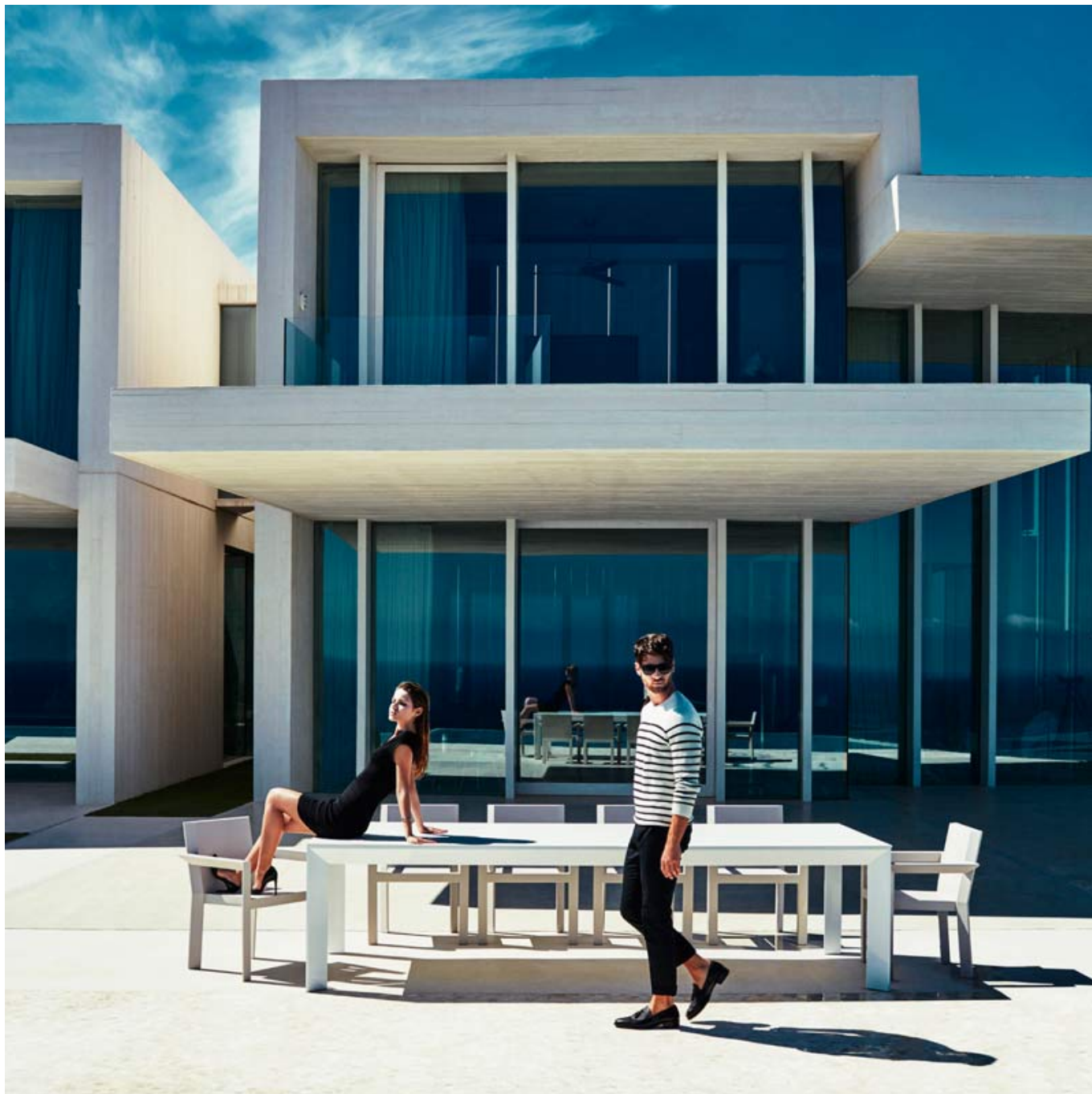

FRAME MESA ALUMINIO 100x100x76

By Ramon Esteve



FRAME Collection comes from generating serene and timeless shapes using framework as the elementary geometry. The endless possibilities offered by the material using advanced technology, was the motivation to explore the limits. The FRAME section is flared creating pieces of visual lightness while still definitive and resistant. FRAME meets a wide range of needs in any outdoor space thanks to its variety of pieces. The collection consists of high and low stools, benches, armchairs, a modular sofa, tables of various sizes, chairs and a chaiselongue. The lightness of the pieces as well as the stackable nature of some, such as the chairs and armchairs, make adjustments to their distribution easier and comfortable. Also the chaiselongue, with a reclining backrest, has wheels built into the framework which make moving it easier.

Camo rug will contrast with the surrounding by blurring it. The pattern, initially designed to get integrated with the nature, didn't take long to get into the fashion world in order to get the opposite effect at the urban environment. Today, being trendier than ever, it is available to dress your home in four different tones.

View online: <https://www.vondom.com/products/54117>

Features

Description

Extruded aluminum with cast lacquered aluminum base. HPL Table top. Item suitable for indoor and outdoor use. HPL Table top.

Weight

33.34 Kg



